



**Viking Sink Company** LLC  
 653 TOWER DR - CADOTT, WI 54727  
 715-289-3540 - FAX 715-289-3542

# STANDARD MODULAR SHOWER ORDER FORM "C"

FOR VSC OFFICE USE ONLY

ORDER # \_\_\_\_\_  
 SOC: \_\_\_\_\_ -ROUTE \_\_\_\_\_  
 DELIVERY DATE: \_\_\_\_\_

CUSTOMER: \_\_\_\_\_ PO # \_\_\_\_\_

ADDRESS: \_\_\_\_\_ DATE: \_\_\_\_\_ PHONE: \_\_\_\_\_ JOB NAME: \_\_\_\_\_

ORDERED BY: \_\_\_\_\_ FAX: \_\_\_\_\_ E-MAIL: \_\_\_\_\_

## BATHROOM ACCESSORIES

- SHOWER SEAT
- RECESSED DOUBLE SHAMPOO HOLDER
- RECESSED SINGLE SHAMPOO HOLDER
- SM. CORNER SHAMPOO HOLDER (2-SHELF)
- LG. CORNER SHAMPOO HOLDER (3-SHELF)
- CORNER SOAP DISH
- INSIDE CORNER TRIM 9 FT. LONG
- OUTSIDE CORNER TRIM
- BATTEN STRIP

SPECIAL INSTRUCTIONS

**BASE ONLY -OR- KIT** (BASE, WALLS & INSIDE CORNER TRIM)

BASE COLOR: \_\_\_\_\_

WALL COLOR: \_\_\_\_\_

### NEO ANGLE

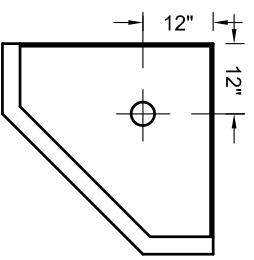

- 36" X 36"
- 38" X 38"
- 42" X 42"

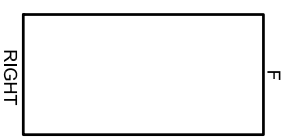
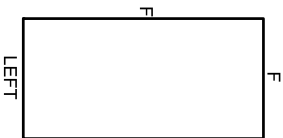

STANDARD PANEL  
HEIGHT 72"  
UNLESS SPECIFIED  
OTHER: \_\_\_\_\_

### SQUARE

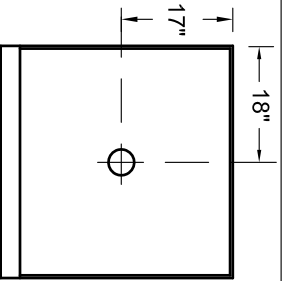

- 36" X 36"

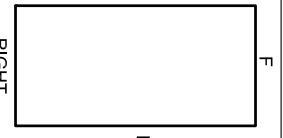
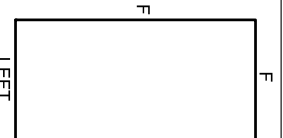

STANDARD PANEL  
HEIGHT 72"  
UNLESS SPECIFIED  
OTHER: \_\_\_\_\_

### CONFIRMED

BY: \_\_\_\_\_

DATE: \_\_\_\_\_

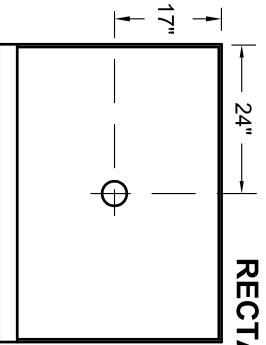

- 36" X 48"

### RECTANGULAR

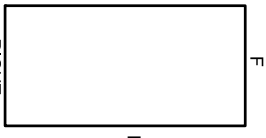
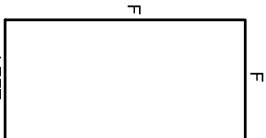

STANDARD PANEL  
HEIGHT 72"  
UNLESS SPECIFIED  
OTHER: \_\_\_\_\_

INCOMPLETE INFORMATION MAY DELAY PROCESSING AND DELIVERY - PLEASE SIGN BELOW AND RETURN

I AGREE AND ACCEPT THE SPECIFICATIONS FOR THE SHOWER AS ORDERED.

DATE: \_\_\_\_\_ SIGNATURE: \_\_\_\_\_

(F) INDICATES  
FINISHED EDGE

**ORDER**

**QUOTE ONLY**